

**Title: COMBINED STAGE 1-2 ROAD SAFETY AUDIT**

**For;**

**Ardrew Halting Site, Athy Co. Kildare.**

**Client: Donnachadh O'Brien & Associates, Consulting Engineers**

**Date: July 2024**

**Report reference: 2336R01**

**VERSION: FINAL (27-9-2024)**

Prepared By:

**Bruton Consulting Engineers Ltd**

Glaspistol

Clogherhead

Drogheda

Co. Louth.

Tel: 041 9881456

Mob: 086 8067075

E: [admin@brutonceng.ie](mailto:admin@brutonceng.ie)

W: [www.brutonceng.ie](http://www.brutonceng.ie)



## CONTENTS SHEET

### Contents

1.0	Introduction.....	2
2.0	Background.....	3
3.0	Issued Raised in This Stage 1-2 Road Safety Audit.....	4
3.1	Problem.....	4
3.2	Problem.....	5
4.0	Observations.....	5
4.1	Observation.....	5
5.0	Audit Statement.....	6
	Appendix A – Problem Location Plan.....	7
	Appendix B – Information Provided.....	8
	Appendix C – Feedback Form.....	9

## 1.0 Introduction

This report was prepared in response to a request from Mr. Bradley Browne, Donnachadh O’Brien & Associates, Consulting Engineers, for a Stage 1-2 Road Safety Audit for the proposed extension and improvement works for Ardrew Halting site in Athy, Co. Kildare.

The Road Safety Audit Team comprised of;

Team Leader: **Norman Bruton**, BE CEng FIEI, Cert Comp RSA.

**TII Auditor Approval no:** NB 168446

Team Member: **Owen O’Reilly**, B.SC. Eng Dip Struct. Eng NCEA Civil Dip Civil. Eng CEng MIEI

**TII Auditor Approval no:** OO 1291756

The Road Safety Audit comprised an examination of the drawings provided and a site visit by the Audit Team on the 19<sup>th</sup> of July 2024.

The weather at the time of the daytime site visit was dry and the road surface was also dry.

This Stage 1-2 Road Safety Audit has been carried out in accordance with the requirements of TII Publication Number GE-STY-01024, dated December 2017.

The scheme has been examined and this report compiled in respect of the consideration of those matters that have an adverse effect on road safety. It has not been examined or verified for compliance with any other standards or criteria.

The problems identified in this report are considered to require action in order to improve the safety of the scheme for road users.

If any of the recommendations within this safety audit report are not accepted, a written response is required, stating reasons for non-acceptance. Comments made within the report under the heading of Observation are intended to be for information only. Written responses to Observations are not required.

A location map showing where each problem occurs is provided in **Appendix A**.

A list of the documents provided to the Audit Team is provided in **Appendix B**.

The feedback form is provided in **Appendix C**.

**STAGE 1-2 RSA – ARDREW HALTING SITE, ATHY  
DOBA**

## 2.0 Background

It is proposed to upgrade and extend the Ardrew halting site in Athy. The site is located off the Fortbarrington Road (L8065) . The existing simple priority access is to be upgraded to include a raised crossing for pedestrians.

New footpaths and lighting is to be provided.

A posted speed limit of 10km/hr is provided at the existing entrance.

The site location is shown below.

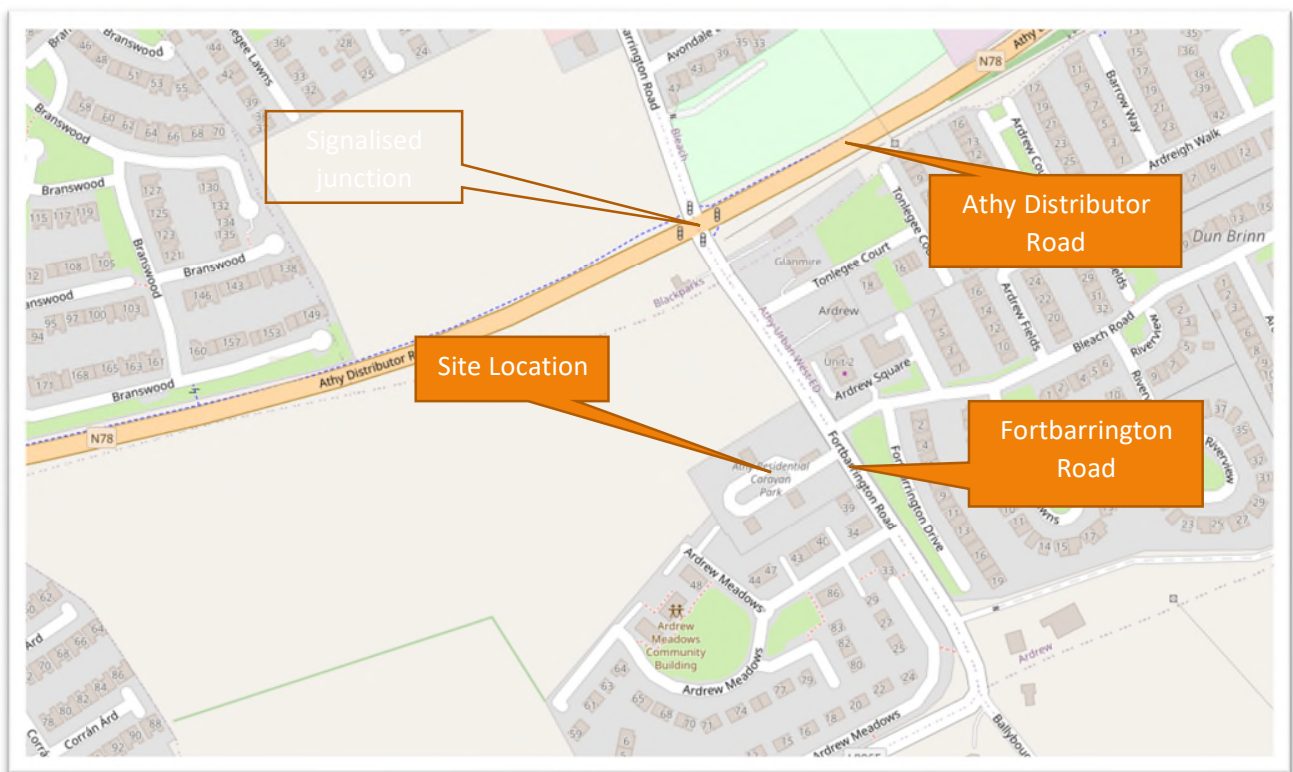

STAGE 1-2 RSA – ARDREW HALTING SITE, ATHY  
DOBA

### 3.0 Issued Raised in This Stage 1-2 Road Safety Audit.

#### 3.1 Problem

##### Location.

Drawing 2327-DOB-ARD-SI-DR-CX-0050 S2 P04, Footpaths.

##### Problem.

There is a discontinuity in the footpath provision at the western side of the circulatory route. This could result in pedestrians stepping into the carriageway when drivers do not expect resulting in collisions.

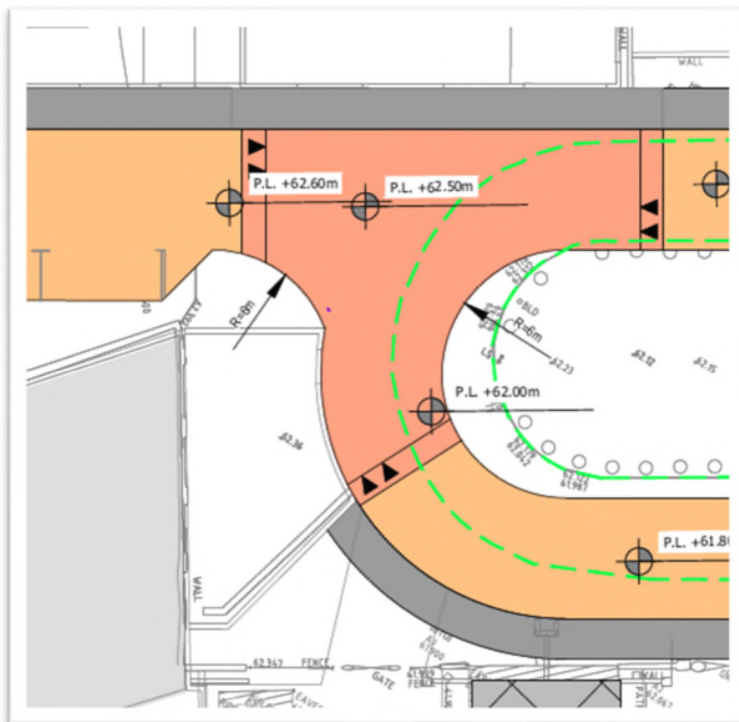

##### Recommendation

It is recommended that a continuous path be provided linking with the path on the northern side.

## STAGE 1-2 RSA – ARDREW HALTING SITE, ATHY DOBA

### 3.2 Problem

#### Location.

Drawing 2327-DOB-ARD-SI-DR-CX-0050 S2 P04, Road markings.

#### Problem.

It is unclear if the circulatory route is to be one-way or two-way and with which route the priority is. A lack of clarity could lead to head-on collisions and side-impact collisions.

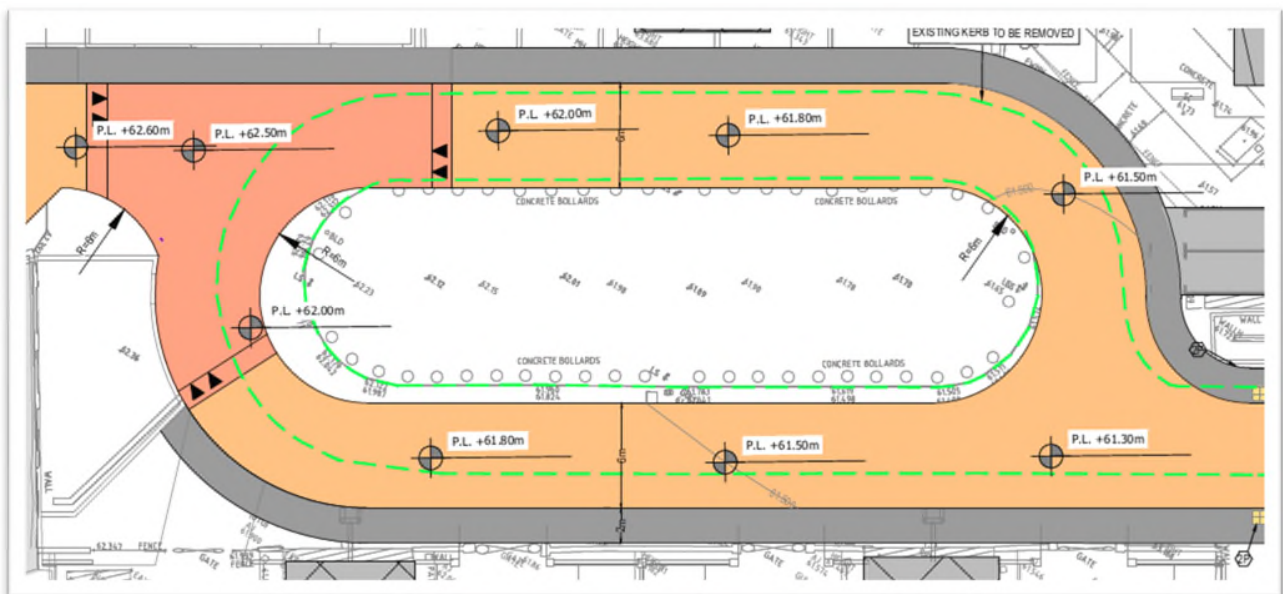

#### Recommendation

It is recommended that road markings be provided to confirm the direction of travel and priority at junctions.

## 4.0 Observations

### 4.1 Observation

It is not known if special towing vehicles will be required to transport temporary dwellings to the site and if the swept path analysis for those vehicles has been carried out.

## 5.0 Audit Statement

We certify that we have examined the material provided and the site. The examination has been carried out with the sole purpose of identifying any aspects of the design which could be added, removed or modified in order to improve the safety of the scheme.

The problems identified have been noted in this report together with associated safety improvement suggestions which we would recommend should be studied for implementation. The audit has been carried out by the persons named below who have not been involved in any design work on this scheme as a member of the Design Team.

**Norman Bruton**

Signed: 

**(Audit Team Leader)**

Dated: 27-9-2024

**Owen O'Reilly**

Signed: 

**(Audit Team Member)**

Dated: 27-9-2024

Appendix A – Problem Location Plan

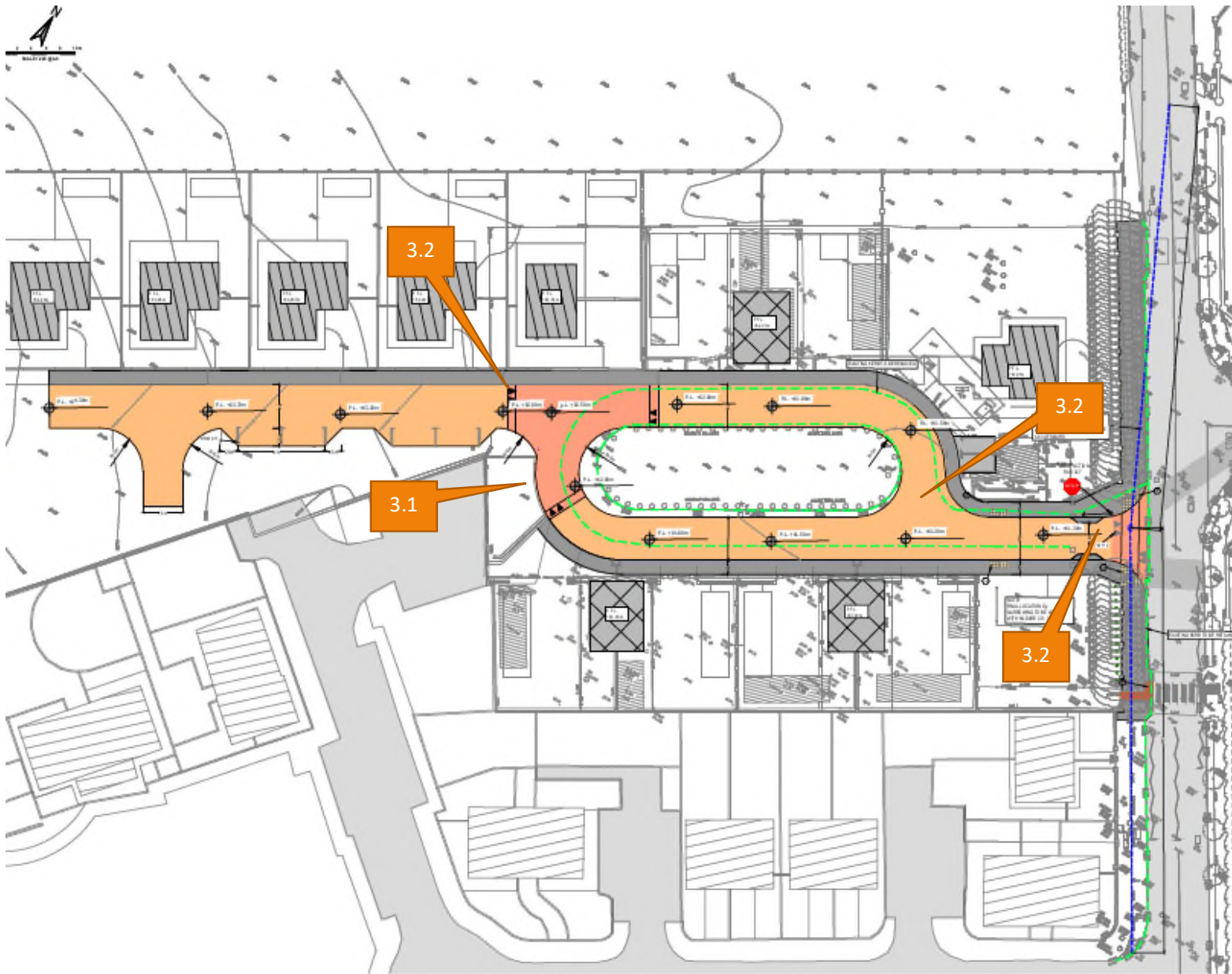



## Appendix B – Information Provided

### Information Supplied to the Audit Team

Drawing 2327-DOB-ARD-SI-DR-C-0030-S2.P02\_Pr. WW Layout  
Drawing 2327-DOB-ARD-SI-DR-C-0040-S2.P02\_Pr. WS Layout  
Drawing 2327-DOB-ARD-SI-DR-C-0045-S2.P02\_Pr. Combined  
Drawing 2327-DOB-ARD-SI-DR-C-0050-S2.P04\_Pr. Site Layout  
Drawing 2327-DOB-ARD-SI-DR-C-0070-S2.P02\_Pr. Autotrack 1  
Drawing 2327-DOB-ARD-SI-DR-C-0071-S2.P02\_Pr. Autotrack 2  
Drawing 2327-DOB-ARD-SI-DR-C-0072-S2.P02\_Pr. Autotrack 3  
Drawing 2327-DOB-ARD-SI-DR-C-0110-S2.P01\_Pr. Siteworks  
Drawing 2327-DOB-ARD-SI-DR-C-0140-S2.P03\_Pr.SW Sect 1  
Drawing 2327-DOB-ARD-SI-DR-C-0141-S2.P03\_Pr.SW Sect 2  
Drawing 2327-DOB-ARD-SI-DR-C-0145-S2.P03\_PR.WW Sections  
Drawing 02\_Landscape Details\_R0  
Drawing 2327-DOB-ARD-SI-DR-C-0001-S2.P02\_EX. Site Layout  
Drawing 2327-DOB-ARD-SI-DR-C-0005-S2.P02\_EX. Services  
Drawing 2327-DOB-ARD-SI-DR-C-0020-S2.P03\_Pr. SW Layout  
Drawing 2327-DOB-ARD-SI-DR-C-0025-S2.P03\_Pr. SuDS Layout  
Drawing 2327-DOB-ARD-SI-DR-C-0026-S2.P01\_Pr. SuDS Detail  
Report Ardrew Halting Site Calc  
Drawing Ardrew Halting Site D1  
Drawing 01\_Landscape Design\_R0

## Appendix C – Feedback Form

### Feedback Form

**SAFETY AUDIT FORM – FEEDBACK ON AUDIT REPORT**

Scheme: Ardrew halting Site, Athy.

Stage: 1-2 Road Safety Audit

Date Audit (Site Visit) Completed: 19-7-2024

Paragraph No. in Safety Audit Report	Problem accepted (yes/no)	Recommended measure accepted (yes/no)	Alternative measures (describe)	Alternative measures accepted by Auditors (Yes/No)
3.1	YES	YES		
3.2	YES	YES		

Signed.....*B. Browne*.....  
Design Team Leader

Date...27/09/2024.....

Signed.....*Norman Bawton*.....  
Audit Team Leader

Date...27-9-2024.....

Signed.....*B. Browne*.....  
Employer

Date...27/09/2024.....